

SILVERFLOOR™

EXTRA HEAVY DUTY

DOUBLE SIDED REFLECTIVE FLOOR INSULATION

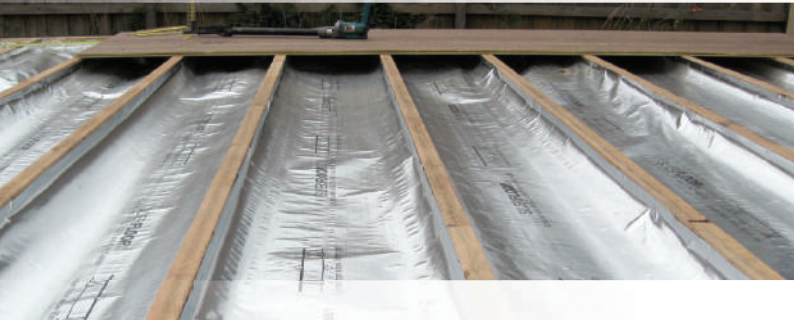

VERY HIGH PERMEANCE

Product Code: SF-30, SF-72, SF-90 | I/N: 0810125, 0810892.

SILVERFLOOR™ is an Extra Heavy Duty, Very High Permeance floor insulation, designed for use under floors with a sealed air space between flooring and enclosed sub-floor space. Double-sided reflective surfaces provide increased R-value to your floor system. 5 mm weep holes at 400 mm intervals in the membrane structure allow water and water vapour to permeate through, preventing moisture build-up under flooring.

- ✓ 97% Reflective
- ✓ High strength, light weight
- ✓ Low flammability
- ✓ Reduces draughts through strip flooring

Construction

SILVERFLOOR™ is a flexible six layer product with anti-oxidant ultra-violet stabilised woven polypropylene and polymer flood coat layers, backed on either side with fire-resistant polymer adhesive and 97% reflective aluminium foil.

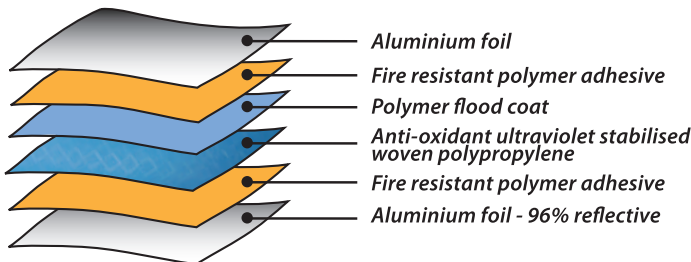

Ametalin utilises Advanced Laminating Technology; the polymer adhesive remains tacky for an indefinite period and provides superior resistance to heat, fire and delamination.

Application

SILVERFLOOR™ is designed for use as an insulation under floors with a sealed air space between flooring and enclosed sub-floor space. Where the sub-floor space is exposed to wind, e.g. in pole construction, a lining should be installed under the floor joists.

Tear Resistance

SILVERFLOOR™ is an extremely lightweight product with superior tear resistance. SILVERFLOOR™ is guaranteed to meet or exceed the minimum performance levels for Extra Heavy Duty rating required under AS/NZS 4200.1:1994.

	Minimum Value*	Actual Test Value
Machine direction edge tear resistance	90 N	410 N / 25 mm
Lateral direction edge tear resistance	90 N	576 N / 25 mm

* Minimum value required to qualify as Extra Heavy Duty under AS/NZS 4200.1:1994.

DECLARED TOTAL SYSTEM R-VALUES

The contribution of this product to the total R-value depends on installation and environmental conditions. The R-value will be reduced in the event of the accumulation of dust on upward facing surfaces and in those cavities that are ventilated.

SUSPENDED FRAMED FLOOR

Typical suspended framed floor, enclosed, unventilated, 90 mm reflective air space, with one layer of SILVERFLOOR 500™ installed between floor joists; or SILVERFLOOR 1200™ / SILVERFLOOR 1500™ installed over bearers or over floor joists.

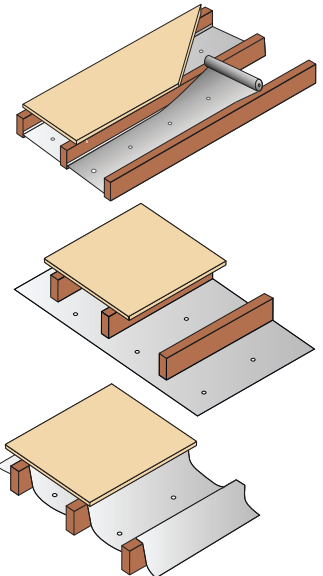

ENCLOSED SUB-FLOOR UNVENTILATED
CALCULATION REF: 299f45 / 12263

WINTER $R_T 3.6$ SUMMER $R_T 1.5$

UNENCLOSED SUB-FLOOR VENTILATED
CALCULATION REF: 12073

WINTER $R_T 2.2$ SUMMER $R_T 0.7$

SILVERFLOOR™

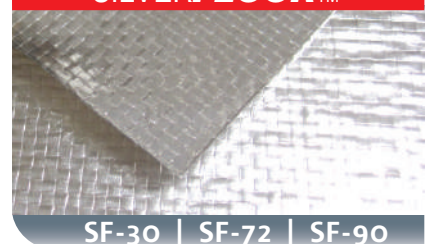

ametalin
raising the standard

Classification

SILVERFLOOR™ classifications under AS/NZS 4200.1:1994

PRODUCT		SILVERFLOOR™	AS/NZS 4200.1:1994
FLAMMABILITY INDEX	AS 1530.2-1993	Low	Low ≤ 5
DUTY	AS/NZS 4200.1:1994	Extra Heavy	Classification
EMITTANCE	AS/NZS 4201.5:1994	SIDE A: 0.03 SIDE B: 0.03	Value
REFLECTIVITY		SIDE A: 97% SIDE B: 97%	Value
RESISTANCE TO WATER PENETRATION	AS/NZS 4201.4:1994	Unclassified	Classification
VAPOUR BARRIER	ASTM E96	Low, PROCEDURE B, WET CUP TEST	Classification
MACHINE DIRECTION TENSILE STRENGTH	AS 1301.448s-91	15.9 kN/m	Min 13.0 kN/m
LATERAL DIRECTION TENSILE STRENGTH	AS 1301.448s-91	14.2 kN/m	Min 10.5 kN/m
MACHINE DIRECTION EDGE TEAR	TAPPI T 470 om-89	319 N	Min 90 N
LATERAL DIRECTION EDGE TEAR	TAPPI T 470 om-89	268 N	Min 90 N
RESISTANCE TO DRY DELAMINATION	AS/NZS 4201.1:1994	Pass	Pass
RESISTANCE TO WET DELAMINATION	AS/NZS 4201.2:1994	Pass	Pass
SHRINKAGE	AS/NZS 4201.3:1994	0.0%	< 0.5%

WATER VAPOUR TRANSMISSION RATES:

SILVERFLOOR 500™ 1973 g/m²·24hr (23°C, 50% RH)

SILVERFLOOR 1200™ 2466 g/m²·24hr (23°C, 50% RH)

SILVERFLOOR 1500™ 1973 g/m²·24hr (23°C, 50% RH)

AMETALIN CLASSIFICATION:

SILVERFLOOR 500™ VERY HIGH PERMEANCE

SILVERFLOOR 1200™ VERY HIGH PERMEANCE

SILVERFLOOR 1500™ VERY HIGH PERMEANCE

NCC/BCA Compliant

SILVERFLOOR™ complies with AS/NZS 4859.1:2002/Amdt 1:2006 and AS/NZS 4200.1:1994, and therefore meets all the requirements of the *National Construction Code* and *Building Code of Australia* for insulation and pliable building membranes.

Total System R-values

R-values apply to typical conditions for mainland Australian capital cities and have been calculated by an independent consulting engineer in accordance with AS/NZS 4859.1:2002/Amdt 1:2006. For detailed design of building systems, seek advice based on actual site conditions from a qualified licensed engineer.

Storage

This product should be stored under cover in a clean, dry place in the pack provided.

Dimensions

SILVERFLOOR™ is sold in sizes:

SILVERFLOOR 500™ 500 mm x 60 m (30 m²)

SILVERFLOOR 1200™ 1200 mm x 60 m (72 m²)

SILVERFLOOR 1500™ 1500 mm x 60 m (90 m²)

Specification Notes

When specifying state the following:

Application: Floors - Suspended Framed Floor

Product Name: SILVERFLOOR™

The insulation to be installed shall be SILVERFLOOR™ double sided reflective laminate, emittance to bright sides 0.03.

Water Vapour Transmission (WVT) and Vapour Resistance:

SILVERFLOOR 500™ / SILVERFLOOR 1500™

1973 g/m²·24hr and 0.06 MN·s/g

SILVERFLOOR 1200™

2466 g/m²·24hr and 0.05 MN·s/g

Vapour Barrier Classification: Low

Water Barrier Classification: Unclassified

Duty: Extra Heavy in accordance with AS/NZS 4200.1:1994

© 2014 Ametalin All Rights Reserved. Ametalin is a division of Amalgamated Metal Industries Pty. Ltd. Product information in this publication and otherwise supplied to users is based on our general experience and is given in good faith, but due to factors outside our knowledge and control which may affect the use of products, no warranty is given or implied with respect to this information or the product itself regarding the suitability of the product for any particular purpose. The usage of this and other building membranes will affect moisture migration in the building element. The purchaser should independently determine the suitability of the product for the intended purpose. For large projects with complex air-conditioning and condensation issues, designers may wish to contact our technical department. Amalgamated Metal Industries Pty. Ltd. reserves the right to amend product specifications without prior notice. Information provided is considered to be true and correct at the time of publication. DTE-41772-27

AUSTRALIAN MADE, AUSTRALIAN OWNED.

AMETALIN

41-43 Birrale Road Regency Park SA 5010

T: +61 8 8347 0941 F: +61 8 8347 0915 E: info@ametalin.com W: ametalin.com

Manufacturers of building membranes | insulation products | flexible packaging



ametalin

raising the standard

Health and Safety Information

Ametalin has assessed SILVERFLOOR™ according to the criteria outlined in the *National Occupational Health and Safety Commission (NOHSC):1008 (1998)* and *NOHSC: 1005 (1999)*. As a result of the assessment, this product is classified as non-hazardous according to the NOHSC criteria. To reduce risk of UV damage when installing this product, wear protective clothing, safety glasses and sunscreen, and work in the shade wherever practical.

Installation

ELECTRICAL SAFETY PRECAUTIONS - BEFORE YOU START:

Ametalin stresses the importance of safe installation practices for foil-based insulation as critical to installer and consumer safety. Aluminium Foil Insulation Association Inc. (AFIA) has prepared Work Method Statements and Hazard Management forms to assist contractors and installers in safe installation of reflective insulation products. These documents are available under 2009 AFIA WMS & Hazard Management, at www.afia.com.au/news/health-and-safety/.

SILVERFLOOR™ should be installed in accordance with AS/NZS 4200.2: 1994 *Pliable Building Membranes and Underlays, Part 2: Installation Requirements*.

INSTALLATION BETWEEN JOISTS

1. Install SILVERFLOOR 500™ between joists.
SILVERFLOOR 500™ is conveniently installed by rolling along the tops of the joists, keeping the material under tension with one hand and fastening with a hammer tacker. To ensure maximum durability, only galvanised staples should be used.

SILVERFLOOR 500™ should be installed at least 90 mm from the underside of flooring, i.e. at the bottom of a standard joist. Joins should overlap by 50 mm and be taped with Ametalin Insulation/Ducting Tape.

INSTALLATION OVER BEARERS

SILVERFLOOR 1200™ and SILVERFLOOR 1500™

1. Roll SILVERFLOOR™ out over the bearers, with minimal sag between the bearers.
2. Staple down with a hammer tacker to hold product in place until joists are installed.
3. Overlap by 50 mm, and tape joins between rolls of SILVERFLOOR™ using Ametalin Insulation/Ducting Tape.
Note: AS/NZS 4200.2:1994 provides for an overlap of 150 mm as an alternative to taping.
4. In external masonry clad houses, the foil should be turned

up and stapled to the underside of flooring, preventing air movement between the sub-floor space and ventilated cavity.

INSTALLATION OVER JOISTS

SILVERFLOOR 1200™ or SILVERFLOOR 1500™ can also be installed over joists with a minimum sag of 90 mm. Joins should overlap by 50 mm and be taped with Ametalin Insulation/Ducting Tape. **Note:** AS/NZS 4200.2:1994 provides for an overlap of 150 mm as an alternative to taping.

RETRO-FIT INSTALLATION

SILVERFLOOR™ should be installed under existing floors in accordance with relevant Aluminium Foil Insulation Association Inc. (AFIA) Safe Work Methods. New Zealand Standard NZS 4246:2006 is helpful. (There is no Australian Installation Standard for this application).

GENERAL

SILVERFLOOR™ is not designed to withstand prolonged direct exposure to the elements. Accordingly, the outer construction envelope of this product should be installed without delay. Aluminium foil should not come into contact with wet concrete or mortar, as the aluminium is susceptible to alkali corrosion. If installed within 500 metres of the sea, or in non-residential buildings where foil surfaces may be exposed to a corrosive atmosphere (including agricultural sheds), foil surfaces should face an enclosed, un-vented air space.

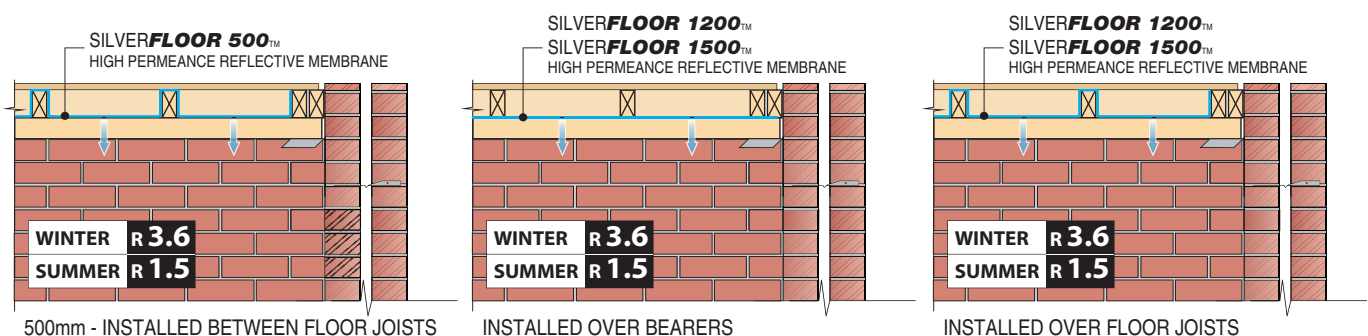

© 2014 Ametalin All Rights Reserved. Ametalin is a division of Amalgamated Metal Industries Pty. Ltd. Product information in this publication and otherwise supplied to users is based on our general experience and is given in good faith, but due to factors outside our knowledge and control which may affect the use of products, no warranty is given or implied with respect to this information or the product itself regarding the suitability of the product for any particular purpose. The usage of this and other building membranes will affect moisture migration in the building element. The purchaser should independently determine the suitability of the product for the intended purpose. For large projects with complex air-conditioning and condensation issues, designers may wish to contact our technical department. Amalgamated Metal Industries Pty. Ltd. reserves the right to amend product specifications without prior notice. Information provided is considered to be true and correct at the time of publication. DTE-41772-27

AUSTRALIAN MADE, AUSTRALIAN OWNED.

AMETALIN

41-43 Birralee Road Regency Park SA 5010

T: +61 8 8347 0941 F: +61 8 8347 0915 E: info@ametalin.com W: ametalin.com

Manufacturers of building membranes | insulation products | flexible packaging



ametalin

raising the standard